

110 REPUBLIC DR.  
NORTH HAVEN, CT

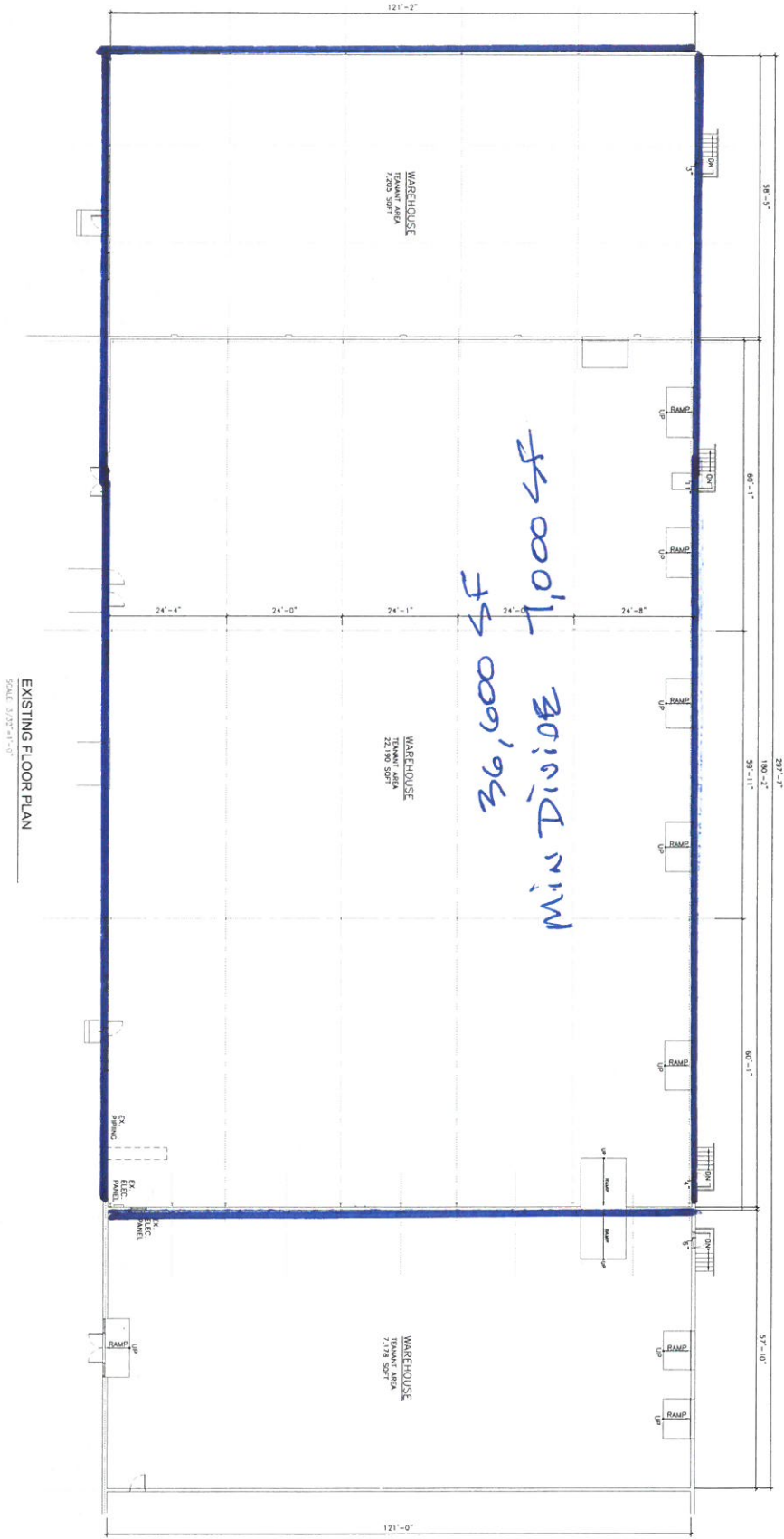

EXISTING FLOOR PLAN  
SCALE 3/32"=1'-0"



EX-01

DRAWING NUMBER: EX-01  
DATE: JULY 21, 2017  
SCALE: 3/32"=1'-0"

DRAWING: EXISTING FLOOR PLAN  
ISSUE: \_\_\_\_\_ DATE: \_\_\_\_\_

PROJECT: PROPOSED TENANT AREA  
110 REPUBLIC DRIVE  
NORTH HAVEN, CT 06473

Prepared by: JAMES C. BELLY, LLC  
4500 BRIDGE ROAD  
NORTH HAVEN, CT 06473  
(203) 927-8202 (O)  
(203) 927-8203 (F)  
jbelly@jshark.com

Client: 200 ELM ASSOC., LLC  
110 REPUBLIC DR, STE 5  
NORTH HAVEN, CT 06473  
(203) 927-3200